

Installation instruction

Deck filler inside installation. Aluminium / Stainless steel

Deck filler: DF40, DF40X, DF50, DF50X, DF40W, DF40WX.

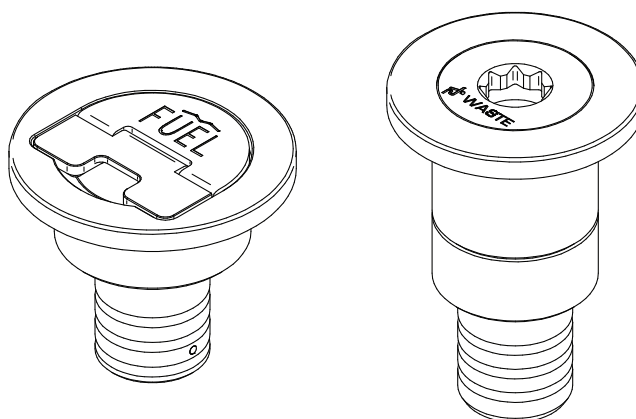

CAUTION. Read all instructions carefully before installing and using this product.

1. REQUIRED FOR INSTALLATION.



Template



Drill



Hole saw



Non acidic degreaser



Polyurethane marine sealant



Anti-corrosion lubricant



Threadlocker

Installation instruction

Deck filler inside installation. Aluminium / Stainless steel

1. TEMPLATE.

Choose the right template of the filler to be fitted and mark position of main hole and screws on the deck (see templates at page 05).
Use a hole saw to cut holes for cylinders and a drill bit to cut holes for screws.

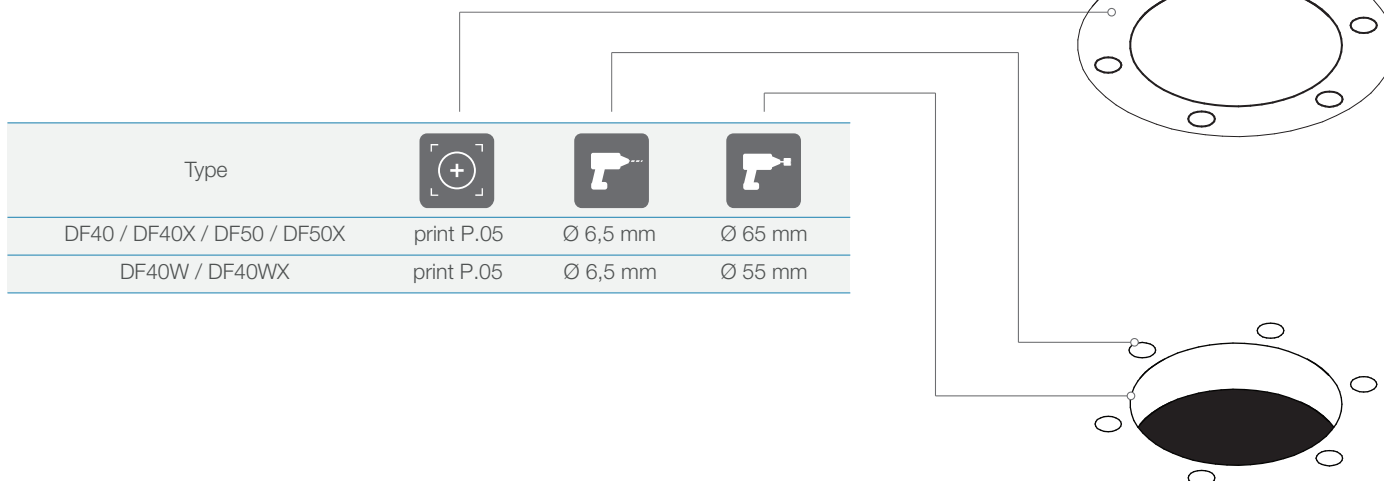

2. PREPARING THE BASE.

Carefully clean the part with a non-acidic degreaser.
Then apply a small bead of marine sealant under the flange / on the deck.

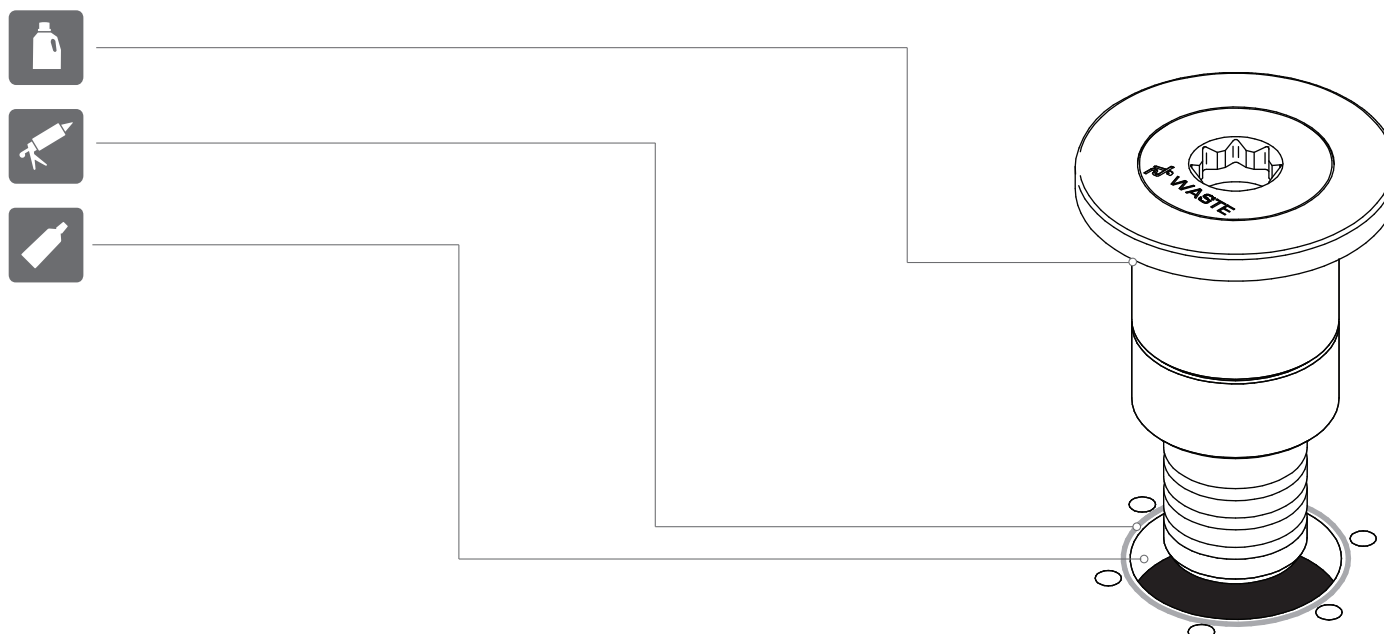

Installation instruction

Deck filler inside installation. Aluminium / Stainless steel

3. INSTALLATION

Place the deck filler into the housing and put the screws with washers. Apply some anti-corrosion lubricant into the screw holes and some threadlocker to the thread. Tighten firmly.

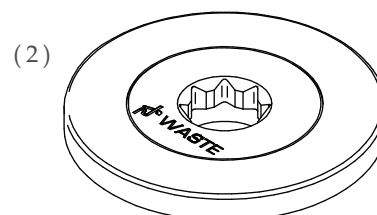
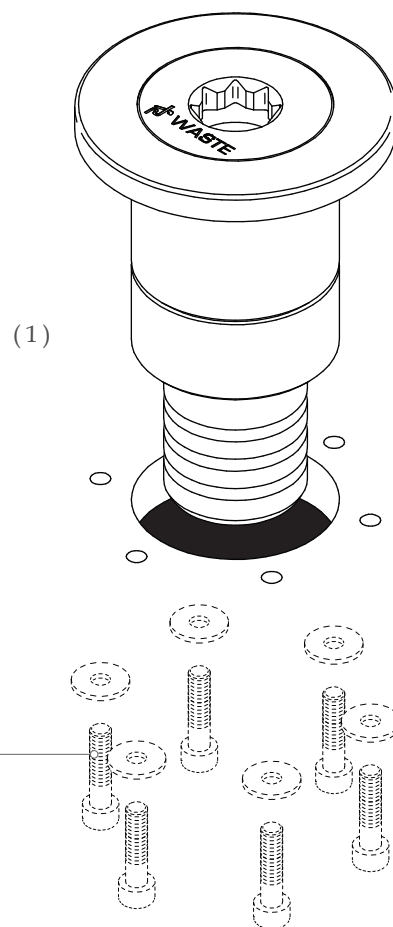

Installation instruction

Deck filler inside installation. Aluminium / Stainless steel

4. DRAINAGE

Once the deck filler is fitted you can connect the piping.

Type	Pipe internal diameter (mm)
DF40 / DF40W / DF40X / DF40WX	Ø 38
DF50 / DF50X	Ø 50

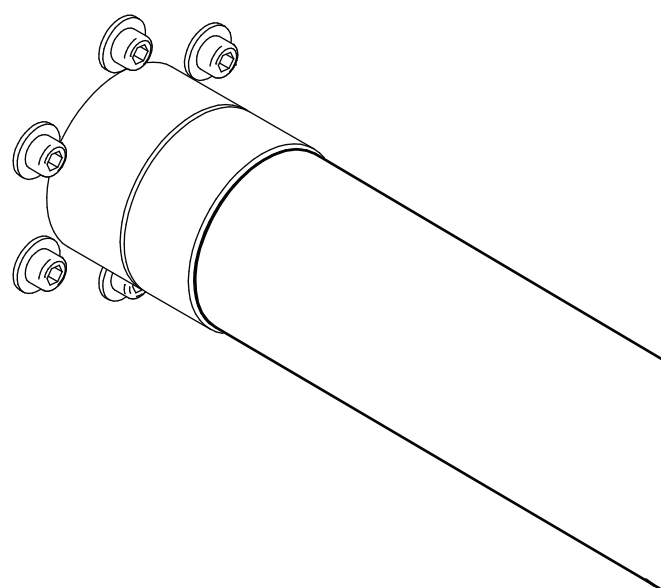
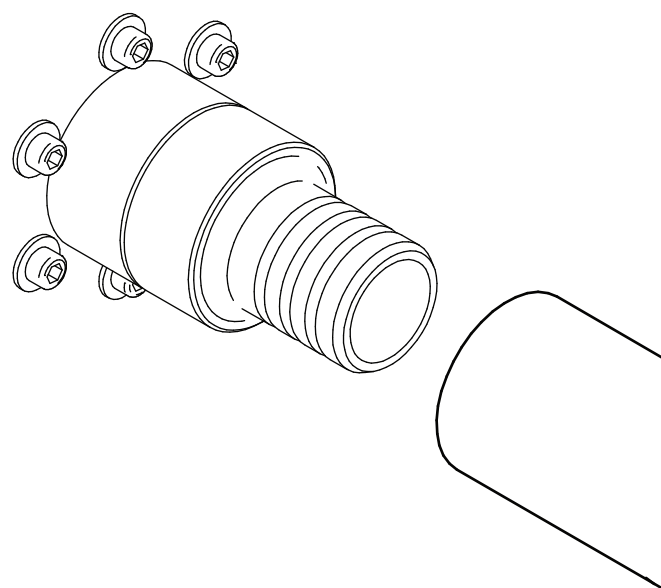



DF40
DF40X
DF50
DF50X

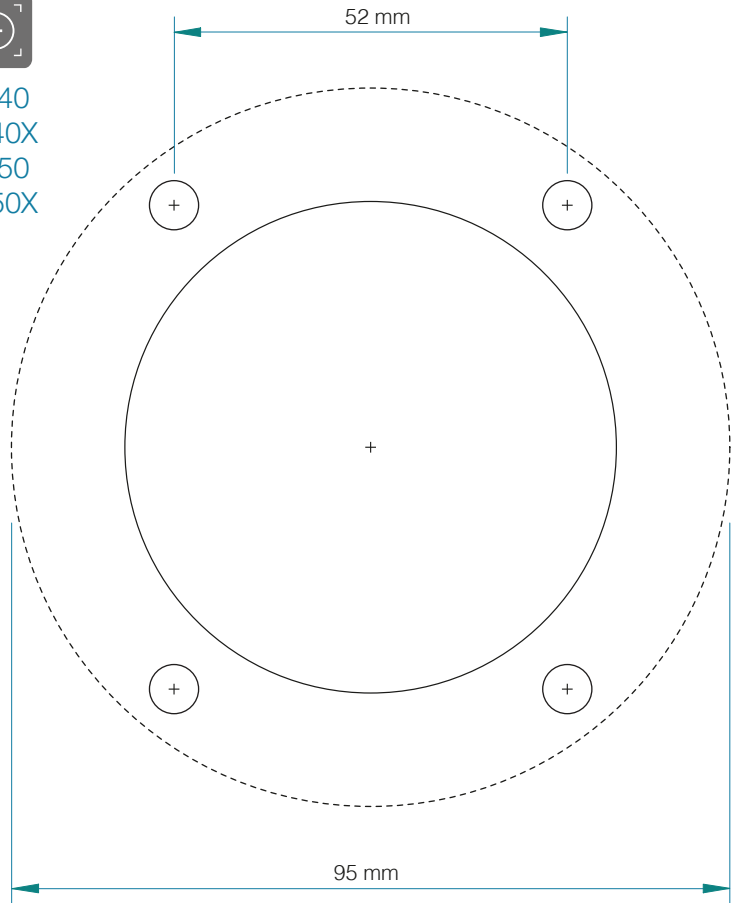

DF40W
DF40WX

